

# Low Loss SAW Filter 64.6 MHz Filter

**Bandwidth 0.13 MHz**

**Part Number A180-64.6M1**

Complies with Directive 2002/95/EC (RoHS)

PRELIMINARY DATA

## Typical performance

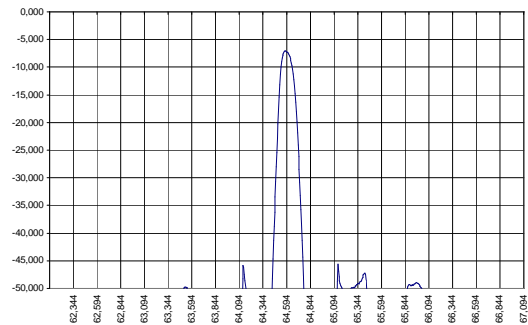
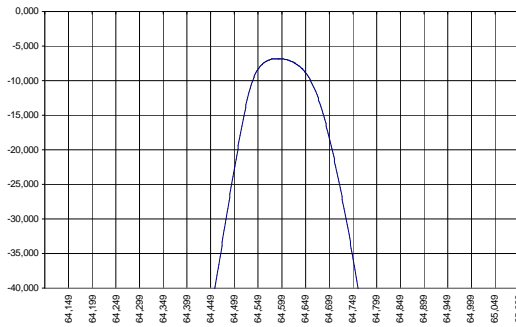

## Specifications

| Parameter                               | Unit | Min    | Typ          | Max    |
|---|------|--------|--------------|--------|
| Central frequency                       | MHz  | 64.590 | 64.600       | 64.610 |
| Inserted loss (unmatched)               | dB   | 5      | 6            | 7      |
| Bandwidth @ -3dB                        | MHz  | 0.12   | 0.13         | 0.14   |
| Bandwidth @ -40dB                       | MHz  | 0.34   | 0.35         | 0.36   |
| Amplitude ripple (in bandwidth 0.1 MHz) | dB   | -      | 1            | 2      |
| Ultimate rejection                      | dB   | -      | 60           | -      |
| Substrate                               |      |        | 36 YX quartz |        |
| Temperature range                       | °C   | -55    |              | 85     |

### Notes:

1. The design, manufacturing process, and specifications of this filter are subject to change.
2. Specification valid for measurements in AEC test fixture

## Case

DIP 18

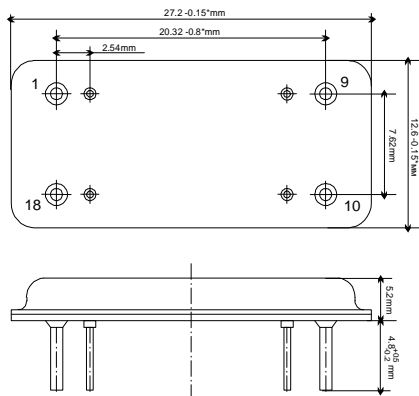

## Matching

